

Loiederman Farm

Opening Spring 2025

The Loiederman Farm and Resilience Hub is located at A. Mario Loiederman Middle School (12701 Goodhill Road, Silver Spring). The farm is managed by the Charles Koiner Conservancy for Urban Farming (CKC). The farm is open to the public during our regular programming hours.

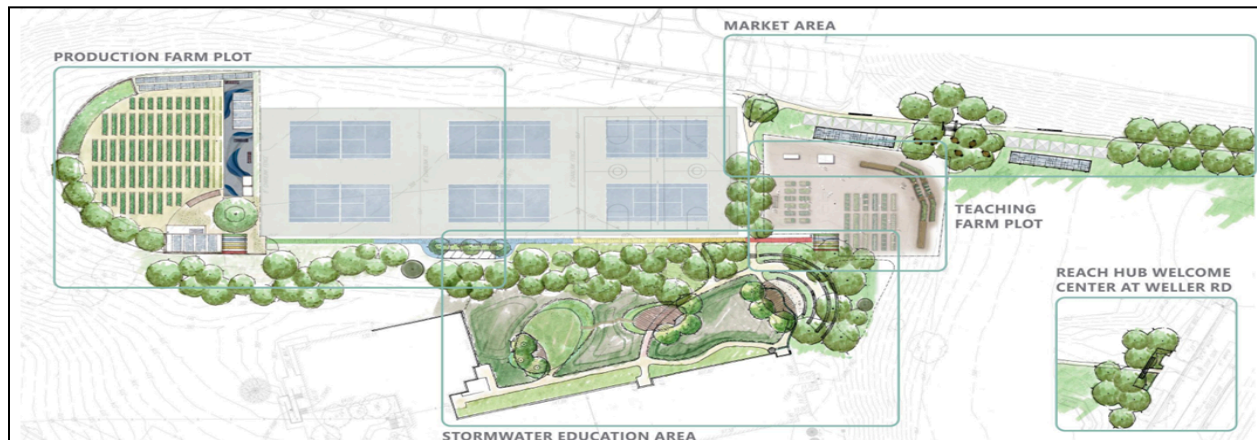

★ **K-8 Field Trips** are offered through Excel Beyond the Bell (EBB) at Loiederman MS and Weller Road ES. If you are a school administrator or teacher interested in a farm visit for your class during school hours, you may reach out to kate@ckcfarming.org to schedule an individual class visit.

★ **High School & College Internships** are 12-week sessions. Sessions begin the first week of March, June and September. Student Service Learning (SSL) hours and stipends are available. [Apply here](#) or via the QR code to the right.



★ **Urban Farmer Volunteerships** run March to November. Farm volunteers must apply in advance (no day-of walk-ins). Volunteer shifts are Sundays from 4-6pm. [Apply here](#) or via the QR code to the right.



★ **Community Liaisons** help connect the farm to the community. The first Liaisons' meeting is April 9, 2025. No pre-registration necessary. Liaisons meet by-monthly throughout the growing season in April, June, and September. Commitment-based stipends available. [Join here](#) or via QR code to the right.



★ **Farmers Markets** scheduled for May 21st, August 20th and October 15th 2025. SNAP/WIC and other payment types accepted. Seeking musicians and food/art vendors. Email Hannah@ckcfarming.org for more information.



The Charles Koiner conservancy for Urban Farming (CKC) is a local nonprofit land trust dedicated to creating and sustaining neighborhood farms that promote healthy living, inspire food system innovation and build community resilience

Find us at Koiner Farm | 737 Easley Street | Silver Spring, MD 20910 | EIN 83-1145521 | www.ckcfarming.org | @ckcfarming